

DRAIN INSTRUCTIONS

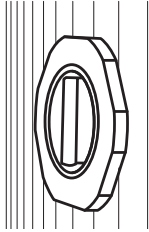

1. Inset closed position.
(Push in to release internal O-Ring seal prior to Step #2)

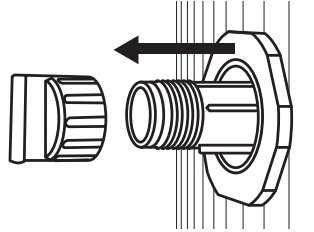

2. Extended closed position
(pull out to fully extended position and remove cap); place cap in safe place.

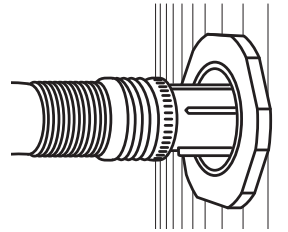

3. Full extended closed position
(attach garden hose in the full extended closed position).

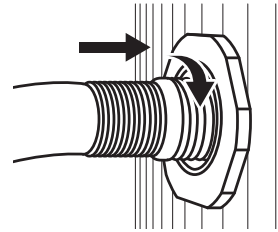

4. Open position for draining
(turn hose and fitting ¼ turn clockwise and insert ½ way to open position for draining).

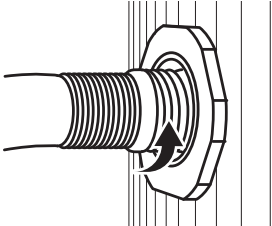

5. Open position for draining
(turn hose and fitting ¼ turn counter clockwise and pull out to full extended closed position).

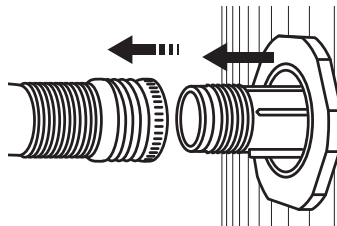

6. Full closed extended position
(remove hose and replace cap).

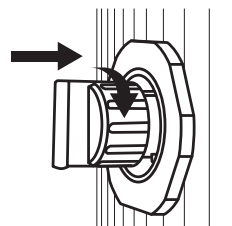

7. With replaced cap screwed on, turn ¼ turn clockwise and push in all the way to inset closed position.

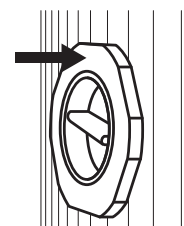

8. Closed inserted position.



Magic Plastics, Incorporated
25215 Avenue Stanford • Valencia, California 91355
(800) 369-0303 • (661) 257-4485 • Fax (661) 257-1911
sales@magicplastics.com • www.magicplastics.com